

❖ 84920-01 - 24" Single Door Vanity

- Inspired by English designs of the 1920's, the Archive collection is sophisticated and inviting
- The doors encompass beautifully reeded wood that bring texture and dimension
- Made of select veneers and premium hardwood construction
- Designed to resist moisture and warpage over time
- Seven step finish applied by hand includes 2 catalyzed polyurethane top coats for moisture resistance and durability
- HPL interior seals and protects from cleaners and toiletries
- Cast metal decorative pulls in a brushed finish
- European robust hinges designed for longevity and repeated use
- Includes adjustable levelers
- Soft-close hinges on door

Nominal Dimensions:

24" x 21" x 35"
(610mm x 533mm x 889mm)

Vanity Colors:



Wenge
610

Cherry
631

Maple
602



Countertop Options:

- ❖ 84960-01 Stone Top - Pre-cut for Marquee Square Undercounter and an 8" widespread faucet

Nominal Dimensions:

24-1/4" x 21-1/4" x 3/4"
(616mm x 540mm x 19mm)

Stone Top Color:



Cream Marble
570

- ❖ 12080 Marquee Square Undercounter Lavatory

Nominal Dimensions:

14-5/8" x 14-5/8" x 7-1/2"
(372mm x 372mm x 191mm)

Lavatory Colors:



White
001



Biscuit
071



Black
178



Matte White
056



Matte Biscuit
107



Matte Black
059

Bowl Inside Dimensions:

11-1/2" (292mm) Wide
11-1/2" (292mm) Front to Back
5-1/2" (140mm) Depth

ROUGH IN DIAGRAM SHOWN
ON REVERSE SIDE

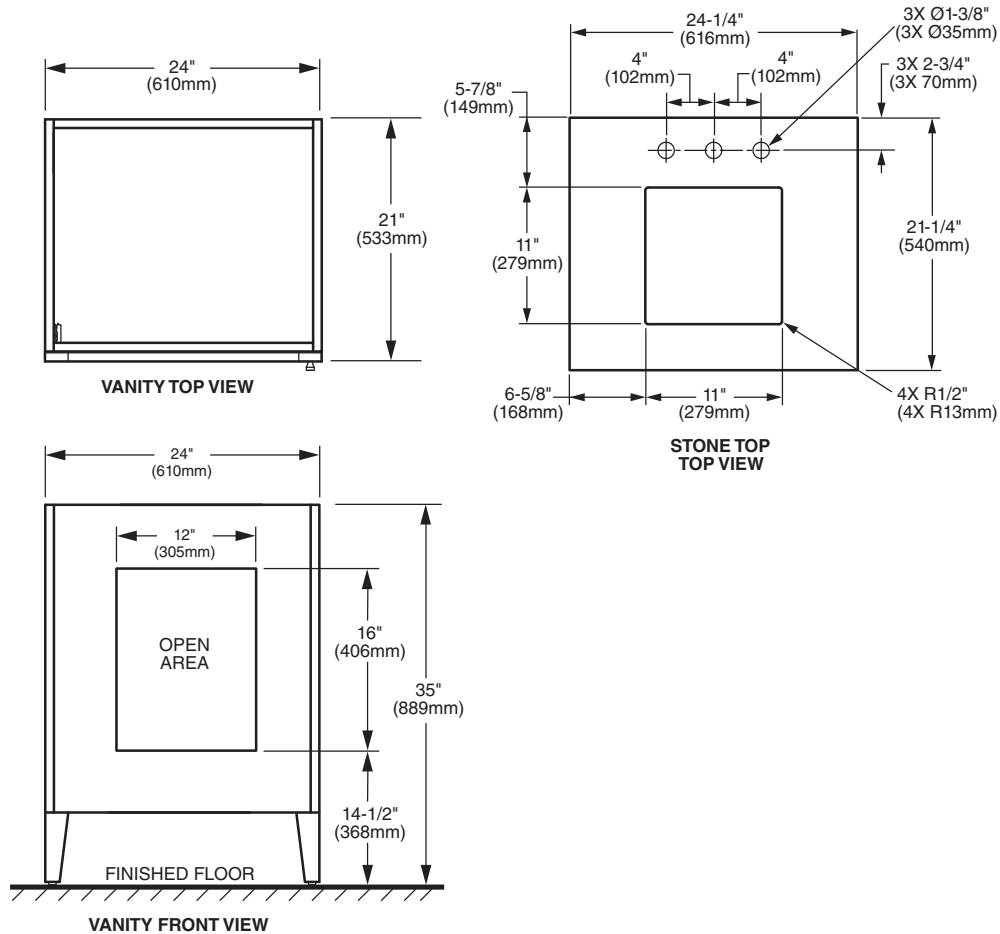

NOTES:

LOCATE SUPPLIES AND "P" TRAP IN OPEN AREA.
 SECURE FURNITURE IN ACCORDANCE WITH INSTALLATION INSTRUCTIONS PROVIDED.
 FITTINGS NOT INCLUDED AND MUST BE ORDERED SEPARATELY.
 INSTALLATION INSTRUCTIONS SUPPLIED WITH LAVATORY.

IMPORTANT: Dimensions of fixtures are nominal and may vary within the range of tolerances established by applicable ASME standards. These measurements are subject to change or cancellation. No responsibility is assumed for use of superseded or voided pages.

To Be Specified:

- Color:
- Faucet:
- Faucet Finish:
- Supplies:
- 1-1/4" Trap:

Compliance Certifications:

- Meets or Exceeds ASME A112.19.2 - 2008/CSA B45.1-08
- CARB Phase I Compliant